

We have moved - Effective 2/7/04

Combi

Combi USA, Inc.

1962 Hwy 160 W, Ste. 100
Fort Mill, SC 29708

1-800-99-COMBI M-F 8:30am-5pm EST

803-548-3663 FAX

New SC
Sales Tax
is 5%



Instruction Manual

Apogee™ Booster Car Seat

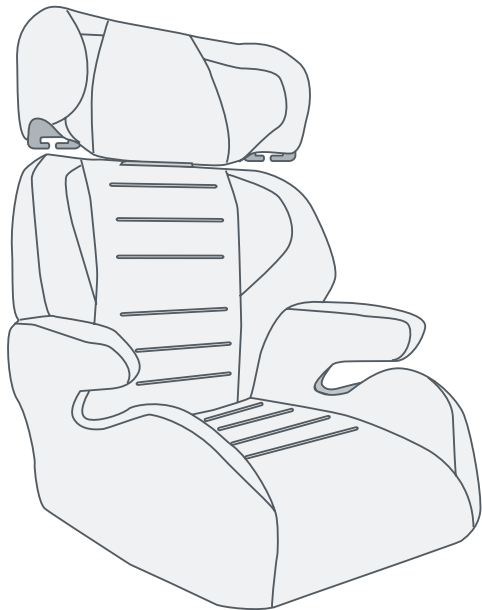

Apogee™ 8200 Series

⚠ WARNING ⚠

Correct installation and use can be a matter of Life or Death! Read and understand these instructions before using this car seat.

- Certified for use in motor vehicles.
- Meets or exceeds all applicable requirements of Federal Motor Vehicle Safety Standard 213.

Para instrucciones en Español,
llamar al: 1-800-992-6624.

Section 1 - Warnings

WARNING **DEATH or SERIOUS INJURY can occur**

- Failure to follow these instructions and car seat labels can result in injury or death to a child from striking the vehicle's interior during a sudden stop or crash.
- Use only with children who weigh between 33 and 100 lbs. (15 and 45 kg) and whose height is between 33 and 57 inches (84 and 145 cm).
- Snugly adjust the lap and shoulder belt around child according to the instructions in the vehicle owner's manual.
 - Vehicle lap belt **MUST** be positioned low on the hips contacting the thighs.
 - Shoulder belt must be properly positioned over shoulder (NOT touching child's neck and NOT off shoulder).
 - Never use shoulder belt loose, positioned under child's arms, or behind child.
 - A snug belt should not allow any slack. It lies in a relatively straight line without sagging. It does not press on the child's flesh or push the child's body into an unnatural position.
- Use only the vehicle's lap and shoulder belt system when restraining the child in this Booster Car Seat.
- Secure this child restraint with the vehicle's child restraint anchorage system if available or with a vehicle belt.
- Never use Booster Car Seat with only a vehicle lap belt across front of child. Use with only a lap belt could result in serious injury or death to a child.
- Not all vehicle seat belts can be used with this Booster Car Seat. Read vehicle owner's manual and Vehicle Seat Belt Systems section in this manual.
- Never use Booster Car Seat with the vehicle's LATCH System.

- Never use Booster Car Seat in a front vehicle seat location unless recommended by vehicle owner's manual.
- To avoid injury, this restraint should be installed and adjusted by an adult. NEVER allow child to buckle themselves in this booster seat.
- Discontinue use of the Booster Car Seat when the top of the child's ears are above top of the seat back or headrest. Severe head or neck injuries could result without proper head support.
- Do not allow child to slide down in Booster Car Seat which could position vehicle lap belt across child's abdomen and shoulder belt over neck or face.
- Vehicle belts MUST lay flat against child and MUST not be twisted.
- If child will not keep vehicle shoulder belt properly positioned, DO NOT use this Booster Car Seat. Use a different child restraint system.
- Secure this child restraint to the vehicle, even when not occupied. Unsecured items may injure occupants in a crash.
- DO NOT use accessories or parts other than those provided by COMBI International Corporation. Use of accessories or parts from other manufacturers could alter the performance of the car seat.
- DO NOT use car seat if it has been in a crash, it must be replaced. A crash can cause unseen damage and continued use could result in serious injury or death.
- DO NOT use car seat if it is damaged, missing instructions, or missing parts.
- Register your child restraint with the manufacturer.

Proper Use Is Required:

No car seat can guarantee protection from injury in every situation, but proper use helps reduce the risk of serious injury or death.

Section 2 - Table of Contents

Section 1. Warnings.....	1
Section 2. Table of Contents.....	3
Section 3. Proper Use Check List.....	4
Section 4. Apogee“ Booster Car Seat Parts.....	5
Section 5. Use Recommendations.....	6
Section 6. Seat Back Assembly.....	7
Section 7. Selecting A Vehicle Seating Location.....	8
• Vehicle Seats.....	9
• Vehicle Seat Belt Systems.....	10
Section 8. High Back Booster Car Seat Use.....	11
Section 9. Booster Car Seat Use (Without Seat Back).....	13
Section 10. Additional Information	
• Certification.....	15
• Aircraft Use.....	15
• Warm Weather.....	15
• Vehicle Seat Protection.....	15
• Instruction Manual Storage.....	15
• Car Seat Useful Life.....	15
Section 11. Care and Cleaning.....	16
Section 12. Registration Information.....	17

Keep this instruction manual for future use.
Store in pocket on back of car seat.

Section 3 - Proper Use Check List

- Proper use is required. Read and understand instructions and car seat labels.
- Secure child in this child restraint with a vehicle lap and shoulder belt as specified in this instruction manual.
- Snugly adjust vehicle lap and shoulder belt around child.
- A vehicle combination lap and shoulder belt **MUST** be used when using booster car seat.
- Do not use only a vehicle lap belt with this booster seat.
- Secure children in back seat whenever possible.
- Never leave child unattended.
- Do not allow anyone (babysitter, relatives, etc.) to use car seat without first understanding all instructions.

Need help installing your booster car seat?

Contact one of the following sources:

- Your vehicle dealer to locate a child safety seat inspection station in your area.
- Call 1-866-SEAT CHECK (1-866-732-8243).
- Visit www.nhtsa.dot.gov and select Child Seat Inspections .
- Visit www.seatcheck.org.
- Contact a certified child passenger safety technician in your area. To locate a certified Child Passenger Safety Technician in your area visit www.nhtsa.dot.gov and select Child Passenger Safety and then select Technician Contact Locator .

Section 4 - Apogee™ Booster Car Seat Parts

HIGH BACK BOOSTER CAR SEAT

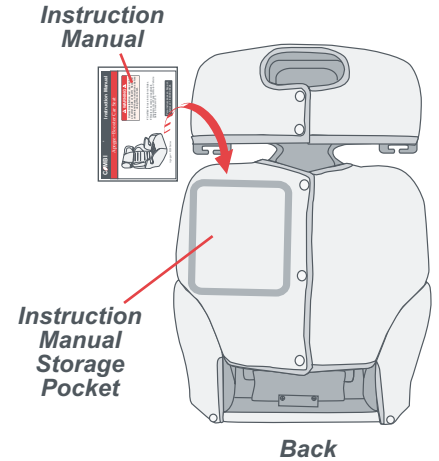
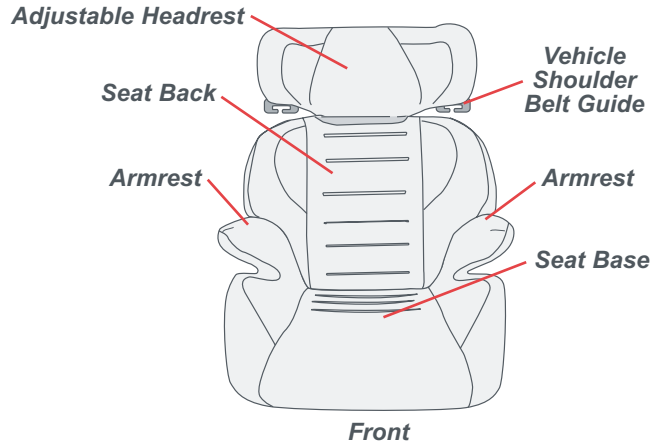

BOOSTER CAR SEAT (WITHOUT SEAT BACK)

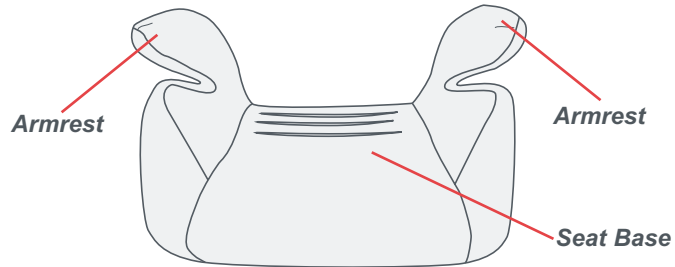

Section 5 - Use Recommendations

Height and Weight Limits:

This child restraint is designed for use only by children who weigh between 33 and 100 pounds (15 and 45 kg) and whose height is between 33 and 57 inches (84 and 145 cm).

This child restraint can be used as a forward-facing booster car seat with or without the seat back. The booster car seat should be used with the seat back as long as possible before removing the seat back and using the seat base only.

HIGH BACK BOOSTER CAR SEAT USE:

Child *MUST* meet all of the following requirements:

- Child weight is between 33 and 100 pounds (15 and 45 kg) and
- Child s height is between 33 and 57 inches (84 and 145 cm) and
- Top of child s ears are below top of seat back.

BOOSTER CAR SEAT (WITHOUT SEAT BACK) USE:

Child *MUST* meet all of the following requirements:

- Child s weight is between 33 and 100 pounds (15 and 45 kg) and
- Child s height is 33 and 57 inches (84 and 145 cm) and
- Top of child s ears are below top edge of vehicle seat back or headrest.



WARNING



DEATH or SERIOUS INJURY can occur

- **Discontinue use of the Booster Car Seat if top of child s ears are above the top edge of seat back or vehicle headrest. Severe head or neck injuries could result without the proper head support.**

Section 6 - Seat Back Assembly

Installing and Removing Seat Back:

To install seat back:

- Place seat bottom on floor or firm surface with arm rests facing down.
- With front of seat back facing down, position round bar at bottom of seat back into slot on back of seat base ① and push seat back down into slot (**fig. a**).

To remove seat back:

- Fully recline seat back and place face down on a firm surface.
- Lift seat back off of seat base.

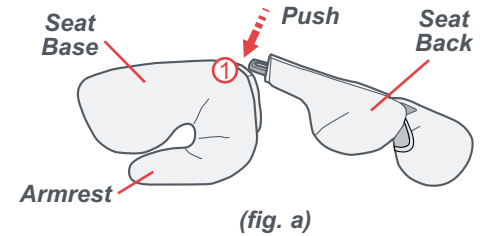

Section 7 - Selecting A Vehicle Seating Location

- 1** National Highway Traffic Safety Administration (NHTSA) alerts vehicle owners that according to accident statistics, children up to age 12 are safer when properly restrained in the rear seating positions rather than the front seating positions.
- 2** Refer to vehicle owner s manual for car seat installation instructions for your vehicle.
 - Use car seat in a rear vehicle seat location whenever possible.
 - Never put a car seat in a front seat location unless recommended by vehicle owner s manual.
 - For vehicles with air bags, refer to vehicle owner s manual for child restraint installation information.
 - If a vehicle front seat location with an air bag must be used, follow the vehicle manufacturer s instructions for child restraint use and move the vehicle seat back as far as possible.
- 3** DO NOT use Booster Car Seat with the vehicle s Child Restraint Anchorage System or LATCH System.

Vehicle Seats

DO NOT use this booster seat on the following types of vehicle seats:



*Seats Which Face
Sides Of Vehicle*

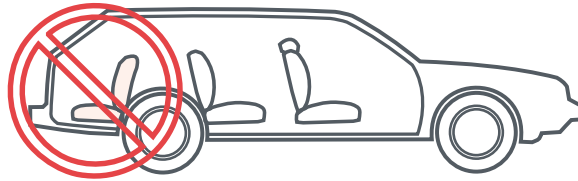

*Seats Which Face
Rear Of Vehicle*

Vehicle Seat Belt Systems

Design and operation of vehicle seat belt systems vary from vehicle to vehicle and from seating location to seating location in the same vehicle. Not all vehicle seat belts can be used with a child restraint. Refer to the information in this section for information on the various types of vehicle seat belt systems.

⚠ WARNING ⚠ DEATH or SERIOUS INJURY can occur

- Use only the vehicle's lap and shoulder belt system when restraining the child in this booster car seat.
- Never use the Booster Car Seat with only a vehicle lap belt.
- Do not allow child to slide down in booster car seat which could position vehicle lap belt across child's abdomen and shoulder belt over neck or face.

DO NOT use this booster car seat with the following types of vehicle seat belts:

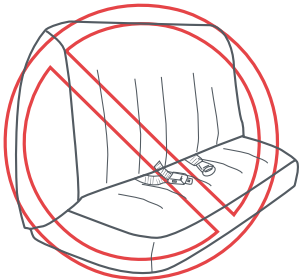

Lap Belt Only

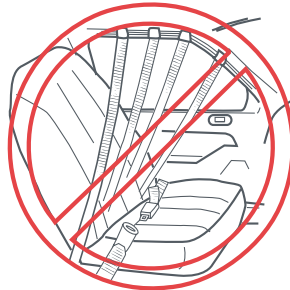

*Passive Restraints
Motorized Shoulder Belt*

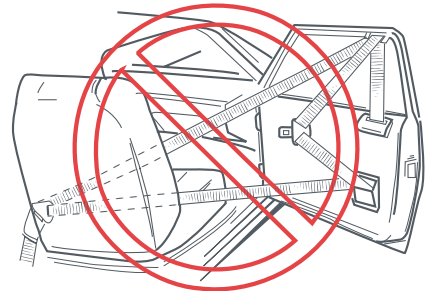

*Passive Restraints
Lap Or Shoulder Belt
Mounted On Front Door*

Section 8 - High Back Booster Car Seat Use

For use with children who weigh between 33 and 100 lbs (15 and 45 kg) and whose height is between 33 and 57 inches (84 and 145 cm).

Securing Child With Lap And Shoulder Belt:

- 1 Select a vehicle seat position which has a lap and shoulder belt.
- 2 If adjustable, position seat back in the upright position.
- 3 Place Booster Car Seat **forward-facing** on vehicle seat and contacting vehicle seat back (**fig. a**).

DO NOT place the Booster Car Seat in a seating position that has only a vehicle lap belt (**fig. b**).

- 4 Position child in Booster Car Seat with back flat against back of car seat.
- 5 Adjust headrest so that shoulder belt guide is at or just above child's shoulder (**fig. c**).



(fig. a)

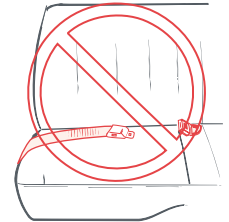

(fig. b)

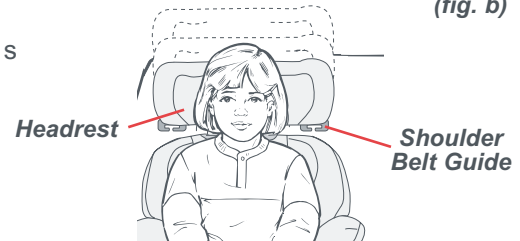

(fig. c)

- 6** Place the vehicle lap and shoulder belt across front of child and buckle seat belt. Position vehicle lap belt under both armrests ① and snugly adjust lap belt. Place the vehicle shoulder belt over child's chest and into the vehicle shoulder belt guide ② (*fig. a*).



(*fig. a*)

- 7** Snugly adjust the lap and shoulder belt according to the instructions in the vehicle owner's manual. Lap belt **MUST** stay under both armrests.

- 8** Check fit of vehicle belts:

- The lap belt must be snug and low on the hips contacting the thighs.
- The shoulder belt must contact the chest and be centered on the shoulder.
- **DO NOT** place shoulder belt under child's arm (*fig. b*) or behind child.

NOTE: Some active children may pull belt out or change position of belts.

- * Do not allow child to slide down under lap belt moving lap belt onto stomach or abdomen.
- * Do not allow child to place shoulder belt under arm or behind back.

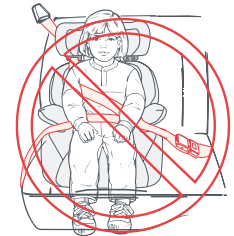

(*fig. b*)

- 9** To adjust the position of the shoulder belt:

- Raise or lower headrest until vehicle shoulder belt is on child's shoulder (*fig. c*).

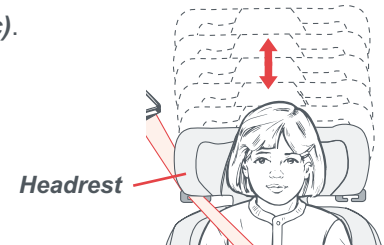

(*fig. c*)

Section 9 - Booster Car Seat Use (Without Seat Back)

For use with children who weigh between 33 and 100 lbs (15 and 45 Kg) and whose height is between 33 and 57 inches (84 and 145 cm).

Securing Child With Lap And Shoulder Belt:

- 1 Remove seat back from High Back Booster Car Seat (see Seat Back Assembly section).
- 2 Select a vehicle seat position which has a lap and shoulder belt.
- 3 If adjustable, position seat back in the upright position.

- 4 Place Booster Car Seat **forward-facing** on vehicle seat and contacting vehicle seat back (*fig. a*).

DO NOT place the Booster Car Seat in a seating position that has only a vehicle lap belt (*fig. b*).

- 5 Position child in Booster Car Seat with child's back flat against vehicle seat back.

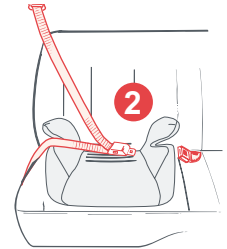

(fig. a)

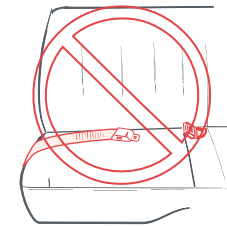

(fig. b)

6 Place the vehicle lap and shoulder belt across front of child and buckle seat belt. Position vehicle lap belt under both armrests ① and snugly adjust lap belt. Place the vehicle shoulder belt over child's chest onto shoulder ② (**fig. a**).

7 Snugly adjust the lap and shoulder belt according to the instructions in the vehicle owner's manual. Lap belt **MUST** stay under both armrests.

8 Check fit of vehicle belts:

- The lap belt must be low on the hips contacting the thighs.
- The shoulder belt must contact the chest and be centered on the shoulder.
- **DO NOT** place shoulder belt under child's arm (**fig. b**) or behind child.

NOTE: Some active children may pull belt out or change position of belts.

- * Do not allow child to slide down under lap belt moving lap belt onto stomach or abdomen.
- * Do not allow child to place shoulder belt under arm or behind back.

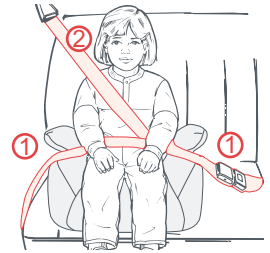

(fig. a)



(fig. b)

Section 10 - Additional Information

Certification

This child restraint system conforms to all applicable Federal Motor Vehicle Safety Standards for use in motor vehicles.

Aircraft Use

This restraint (Booster Car Seat) is not certified for aircraft use (see label on car seat).
An aircraft does not have lap and shoulder belt systems required to use booster car seats.

Warm Weather

Car seat parts can get very hot in the sun or warm weather.

To avoid burns, always check before putting child in car seat.

Vehicle Seat Protection

Protect vehicle seat. Use a thin car seat mat, thin towel, or thin blanket under and behind car seat.

Instruction Manual Storage

Store instruction manual in pocket on back of car seat.

Car Seat Useful Life

DO NOT use after 7 years from date of manufacture on label.

Section 11 - Care and Cleaning

Removing Seat Pad, Back Pad and Headrest Pad:

Open snaps on back of seat back, headrest, and seat base.

Gently slide and pull seat pads from Booster Car Seat.

Reverse above steps for replacing pads.

Cleaning Seat Pad, Back Pad and Headrest Pad:

Hand wash in cool water and mild soap. Roll in towel to remove excess water and lay flat to dry.

Cleaning Shell:

Wipe with mild solution of soap and water. Avoid wetting labels.

Rinse with clean water.

Never use household detergents or solvents.

Section 12 - Registration Information

Child restraints (car seats) could be recalled for safety reasons. You must register this restraint to be reached in a recall. Fill out the registration card attached to car seat and mail today or send your name, address, and the restraint's model number and manufacturing date to:

COMBI International Corporation
199 Easy Street
Carol Stream, IL 60188

or call 1-800-992-6624

or fax 1-630-871-0606

or log onto www.combi-intl.com

For recall information:

- Call the U.S. Government's Auto Safety Hotline at 1-800-424-9393 (202-366-0123 in D.C. area)
- Log onto the National Highway Traffic Safety Administration recall website at:
<http://www-odi.nhtsa.dot.gov/cars/problems/recalls/childseat.cfm>
- Contact COMBI International Corporation (see contact information above)



Keep this instruction manual for future use.
Store in pocket on back of car seat.

We have moved - Effective 2/7/04
Combi
Combi USA, Inc.
1962 Hwy 160 W, Ste. 100
Fort Mill, SC 29708
1-800-99-COMBI M-F 8:30am-5pm EST
803-548-3663 *FAX*

New SC Sales Tax is 5%

© 2003 COMBI International Corporation

ABCS08/03-A

COMBI International Corporation 29708 • 60188 •
Customer Service Telephone 1-800-992-6624 • Se Habla Espa ol 1-630-871-0404 •
Fax 1-630-871-0606 • www.combi-intl.com •
10:00 a.m. - 5:00 p.m. Central Time • Monday - Friday